

PARCEL #1 - Soils Map

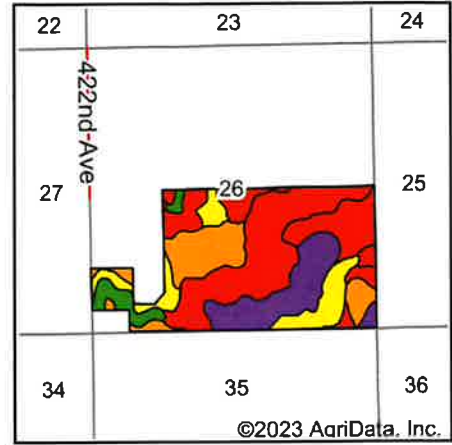

State: **South Dakota**
 County: **Clark**
 Location: **26-114N-58W**
 Township: **Hague**
 Acres: **255.58**
 Date: **9/27/2023**

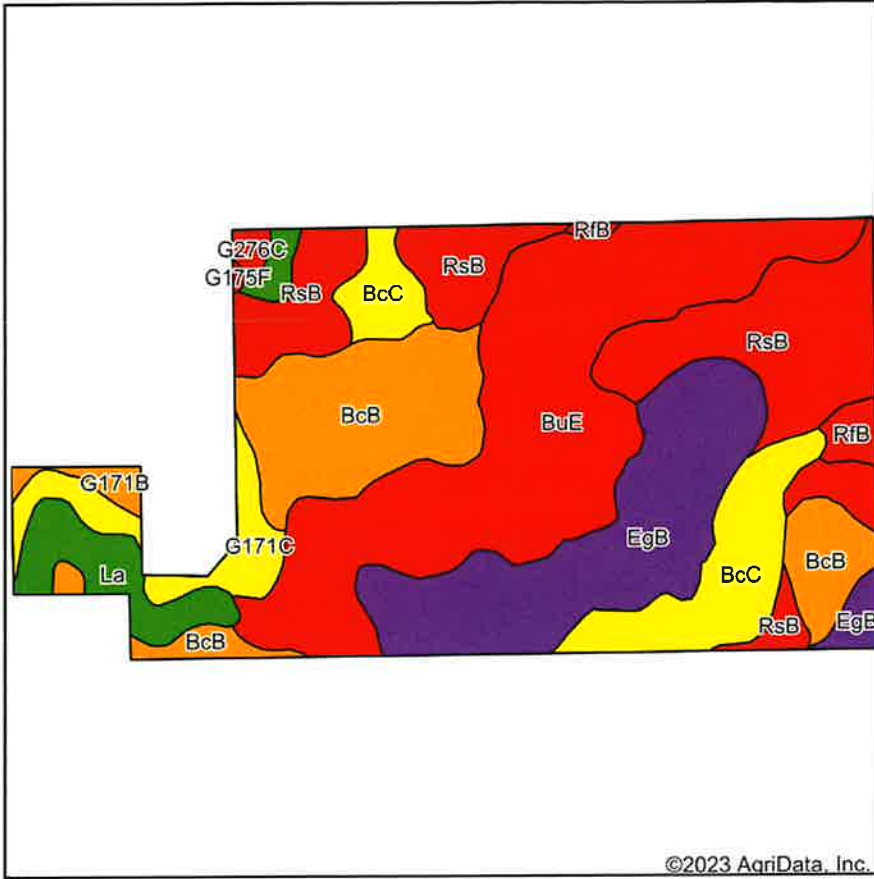

Soils data provided by USDA and NRCS.

Area Symbol: SD025, Soil Area Version: 25						
Code	Soil Description	Acres	Percent of field	PI Legend	Non-Irr Class *c	Productivity Index
BuE	Buse-La Prairie, channeled-Barnes loams, 0 to 40 percent slopes	72.21	28.3%		Vle	21
RsB	Renshaw-Sioux complex, coteau, 2 to 6 percent slopes	48.43	18.9%		IVs	34
EgB	Egeland-Embden complex, 2 to 6 percent slopes	42.62	16.7%		IIIe	57
BcB	Barnes-Buse-Svea loams, 1 to 6 percent slopes	39.28	15.4%		IIe	77
BcC	Barnes-Buse-Svea loams, 2 to 9 percent slopes	23.40	9.2%		IIIe	64
La	La Prairie loam	12.53	4.9%		IIc	92
G171C	Barnes-Buse-Svea loams, 1 to 9 percent slopes	10.35	4.0%		IIIe	61
RfB	Renshaw-Fordville loams, coteau, 2 to 6 percent slopes	3.05	1.2%		IVs	43
G171B	Barnes-Buse-Svea loams, 0 to 6 percent slopes	2.24	0.9%		IIe	72
G276C	Renshaw-Sioux complex, 6 to 9 percent slopes	1.23	0.5%		Vle	29
G175F	Buse-La Prairie, frequently flooded-Barnes loams, 0 to 40 percent slopes, channeled	0.24	0.1%		Vle	25
Weighted Average					3.85	47.9

*c: Using Capabilities Class Dominant Condition Aggregation Method
 Soils data provided by USDA and NRCS.

PARCEL #2 - Soils Map

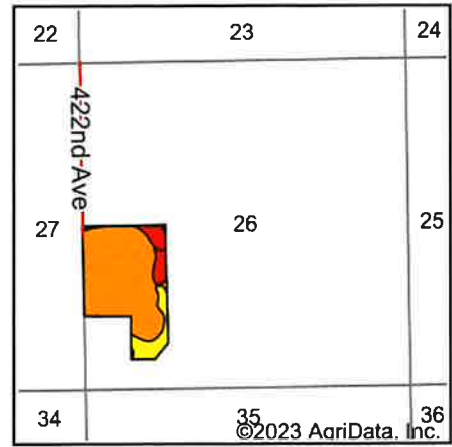
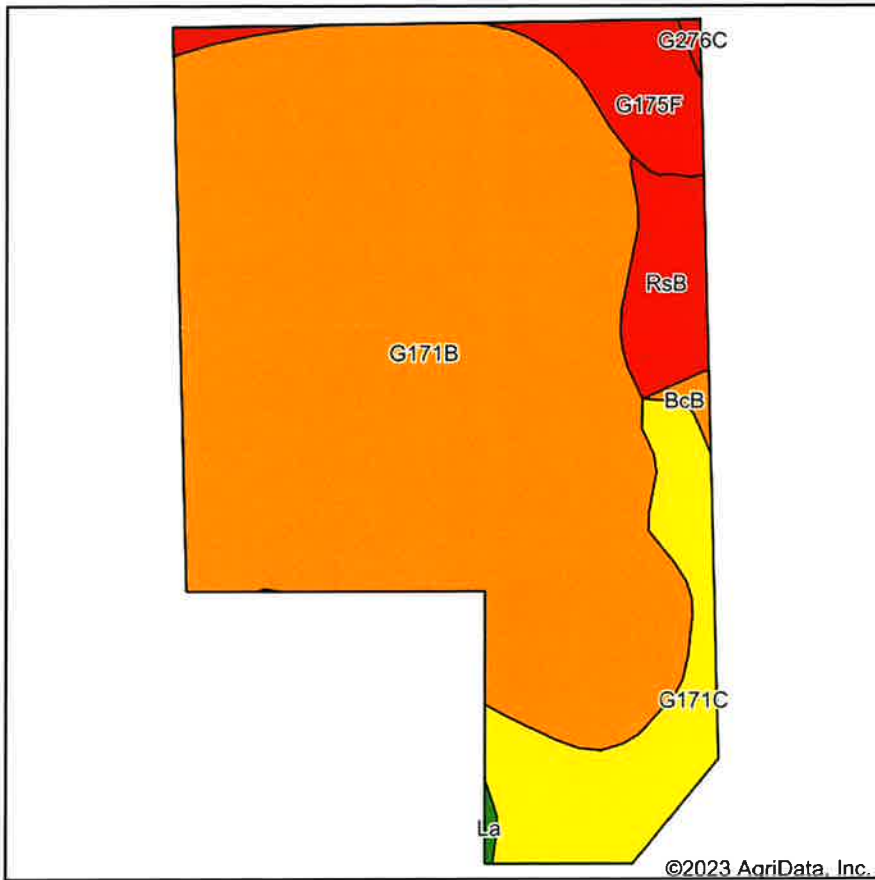

State: **South Dakota**
 County: **Clark**
 Location: **26-114N-58W**
 Township: **Hague**
 Acres: **54.15**
 Date: **9/27/2023**



Soils data provided by USDA and NRCS.

Area Symbol: SD025, Soil Area Version: 25

Code	Soil Description	Acres	Percent of field	PI Legend	Non-Irr Class *c	Productivity Index
G171B	Barnes-Buse-Svea loams, 0 to 6 percent slopes	42.24	78.0%		Ile	72
G171C	Barnes-Buse-Svea loams, 1 to 9 percent slopes	6.08	11.2%		IIle	61
G175F	Buse-La Prairie, frequently flooded-Barnes loams, 0 to 40 percent slopes, channeled	2.88	5.3%		Vle	25
RsB	Renshaw-Sioux complex, coteau, 2 to 6 percent slopes	2.47	4.6%		IVs	34
BcB	Barnes-Buse-Svea loams, 1 to 6 percent slopes	0.26	0.5%		Ile	77
G276C	Renshaw-Sioux complex, 6 to 9 percent slopes	0.11	0.2%		Vle	29
La	La Prairie loam	0.11	0.2%		IIc	92
Weighted Average					2.42	66.5

*c: Using Capabilities Class Dominant Condition Aggregation Method
 Soils data provided by USDA and NRCS.

Soils Map Unit

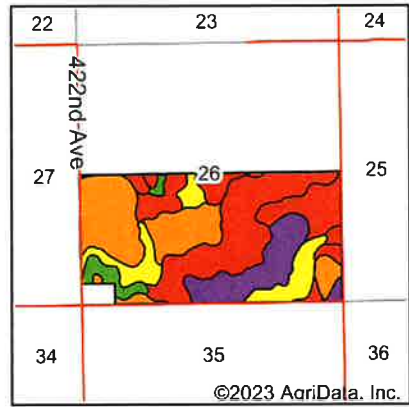
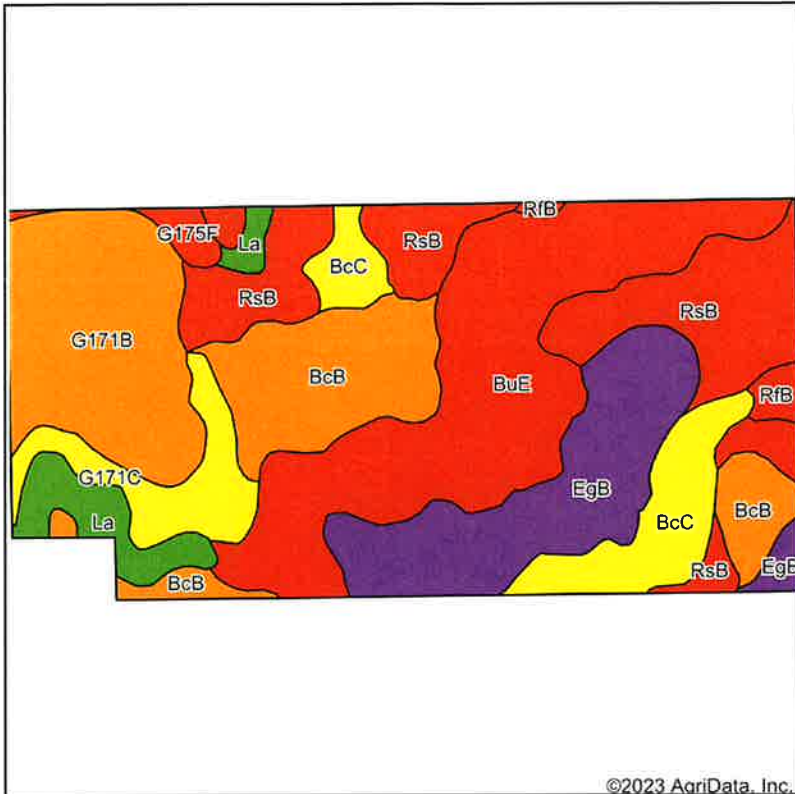

State: **South Dakota**
 County: **Clark**
 Location: **26-114N-58W**
 Township: **Hague**
 Acres: **309.8**
 Date: **9/24/2023**



Maps Provided By:



Soils data provided by USDA and NRCS.

©2023 AgriData, Inc.

© AgriData, Inc. 2023

www.AgriDataInc.com

Area Symbol: SD025, Soil Area Version: 25

Code	Soil Description	Acres	Percent of field	PI Legend	Non-Irr Class *c	Productivity Index
BuE	Buse-La Prairie, channeled-Barnes loams, 0 to 40 percent slopes	72.36	23.4%		Vle	21
RsB	Renshaw-Sioux complex, coteau, 2 to 6 percent slopes	50.91	16.4%		IVs	34
G171B	Barnes-Buse-Svea loams, 0 to 6 percent slopes	44.37	14.3%		Ile	72
EgB	Egeland-Embden complex, 2 to 6 percent slopes	42.83	13.8%		IIIe	57
BcB	Barnes-Buse-Svea loams, 1 to 6 percent slopes	39.72	12.8%		Ile	77
BcC	Barnes-Buse-Svea loams, 2 to 9 percent slopes	23.63	7.6%		IIIe	64
G171C	Barnes-Buse-Svea loams, 1 to 9 percent slopes	15.89	5.1%		IIIe	61
La	La Prairie loam	12.57	4.1%		IIc	92
G175F	Buse-La Prairie, frequently flooded-Barnes loams, 0 to 40 percent slopes, channeled	3.13	1.0%		Vle	25
RfB	Renshaw-Fordville loams, coteau, 2 to 6 percent slopes	2.98	1.0%		IVs	43
G276C	Renshaw-Sioux complex, 6 to 9 percent slopes	1.41	0.5%		Vle	29
Weighted Average					3.61	51.1

*c: Using Capabilities Class Dominant Condition Aggregation Method

Soils data provided by USDA and NRCS.