

PLAT OF
LOT 1 OF GEDNALSKE ADDITION IN GOVERNMENT LOT 4 OF SECTION 5,
T108N, R50W OF THE 5TH P.M., MOODY COUNTY, SOUTH DAKOTA.

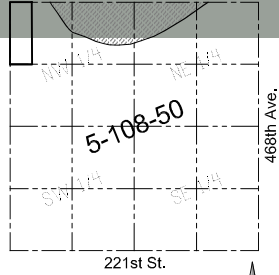

3891.47'
N1°32'20\"/>

SW Corner
5-108-50



Vicinity Map



November, 2023
 Scale: 1" = 200'
 ○ Monument Recovered
 ● Monument Set
 (5/8)" x 18" Capped Rebar RLS 15743)
 Bearings are Based on Assumed Datum

SURVEYOR'S CERTIFICATE

I, John D. Schinkel, a Registered Land Surveyor of the State of South Dakota, do hereby certify that on or before the 27th day of November, 2023 and at the request of the owner of the real property hereinafter described, surveyed and platted a portion of Government Lot 4 of Section 5, Township 110 North, Range 50 West of the 5th P.M, Moody County, South Dakota, as shown on the plat, and marked upon the ground boundaries thereof in the manner shown on the plat, and that the attached plat is a true and correct representation of said survey and that the parcel of land so platted contains: **"PLAT OF LOT 1 OF GEDNALSKE ADDITION IN GOVERNMENT LOT 4 OF SECTION 5, T110N, R50W OF THE 5TH P.M., MOODY COUNTY, SOUTH DAKOTA"**.

IN WITNESS WHEREOF, I have executed this Surveyor's Certificate this 27th day of November, 2023.

Prepared By:



Civil Engineers & Land Surveyors
 Brookings, South Dakota
 Ph. 605-696-3200

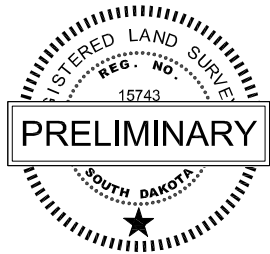

OWNER'S CERTIFICATE

We, Joey Gednalske and Lynn Gednalske, Trustees of the Joey and Lynn Gednalske Trust, dated the 8th day of March 2019, owners of the tract of land shown in the foregoing plat, hereby certify that we do authorize and do join in, and approve the above survey and plat, and that the development of this land shall conform to all existing applicable zoning, subdivision and erosion and sediment control regulation. Any land shown in the above plat and designated as a street, road, alley, park or public ground is hereby dedicated to public land use as such forever, but such dedication shall not be construed to be a donation of the fee of such land.

The portion so platted shall hereafter be designated as "**PLAT OF LOT 1 OF GEDNALSKE ADDITION IN GOVERNMENT LOT 4 OF SECTION 5, T110N, R50W OF THE 5TH P.M., MOODY COUNTY, SOUTH DAKOTA**".

IN WITNESS WHEREOF, We have executed this Owner's Certificate this _____ day of _____, 2023.

Joey Gednalske (Trustee)

Lynn Gednalske (Trustee)

STATE OF _____)
) SS
COUNTY OF _____)

On this _____ day of _____, 20____, before me, the undersigned Notary Public within and for the State and County aforesaid, personally appeared Joey Gednalske and Lynn Gednalske, who acknowledge themselves to be Trustees of the Joey and Lynn Gednalske Trust, dated the 8th day of March 2019, and that they, as being authorized to do so, executed the foregoing instrument for the purposes therein contained, by signing the name of the Joey and Lynn Gednalske Trust, dated the 8th day of March 2019, themselves as Trustees.

NOTARY PUBLIC
My commission expires: _____

CERTIFICATE OF COUNTY PLANNING DIRECTOR

I, the Chair of the Moody County Planning Commission do hereby certify that this plat has been reviewed by me or my authorized agent and has been approved.

Approved on the _____ day of _____, 2023.

CHAIR, COUNTY PLANNING COMMISSION
MOODY COUNTY, SOUTH DAKOTA

COUNTY COMMISSION

BE IT RESOLVED by the County Commission of Moody County, South Dakota, that the plat of **LOT 1 OF GEDNALSKE ADDITION IN GOVERNMENT LOT 4 OF SECTION 5, T110N, R50W OF THE 5TH P.M., MOODY COUNTY, SOUTH DAKOTA** be and the same is hereby approved.

I hereby certify that the above is a correct copy of the resolution duly passed by the County Commission, at a meeting held on the date adopted.

Adopted this _____ day of _____, 2023.

COUNTY AUDITOR
MOODY COUNTY, SOUTH DAKOTA

DIRECTOR OF EQUALIZATION

I, the Director of Equalization of Moody County, South Dakota, do hereby certify that a copy of the above plat has been filed in my office.

Dated this _____ day of _____, 2023.

DIRECTOR OF EQUALIZATION
MOODY COUNTY, SOUTH DAKOTA

COUNTY TREASURER'S CERTIFICATE

I, Treasurer of Moody County, South Dakota, hereby certify that all taxes which are liens upon any land included in the above (and the foregoing) plats, as shown by the records of my office, have been fully paid.

Dated this _____ day of _____, 2023.

TREASURER
MOODY COUNTY, SOUTH DAKOTA

REGISTER OF DEEDS

STATE OF SOUTH DAKOTA)
) SS
COUNTY OF MOODY)

Filed for record this _____ day of _____, 2023, at _____ o'clock _____ M., and recorded in Plat Document # _____, Envelope # _____.

REGISTER OF DEEDS
MOODY COUNTY, SOUTH DAKOTA

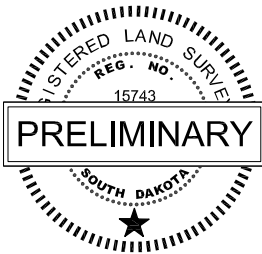

Prepared By:
 CIVIL DESIGN INC
Civil Engineers & Land Surveyors
Brookings, South Dakota
Ph. 605-696-3200