

# Brookings County, SD

## Summary

Parcel ID 340750010000800  
 Property Address 510 ANTELOPE ST S  
 Sec/Twp/Rng N/A  
 Brief Tax Description BROWN'S PLAT ADDN LOTS 8 & 9 BLK 1 100 X 165  
 (Note: Not to be used on legal documents)  
 Comments  
 Class NADS  
 Tax District 3403  
 Gross Acres 0.00  
 \$/Acre N/A



## Owners

Deed Holder  
 DEXTER, DEAN E

510 ANTELOPE ST S  
 ELKTON SD 57026

## Land

Gross Acres 0.00  
 Lot Size N/A

## Building

Residential Dwelling  
 Occupancy Single family - Owner  
 Style 23 Older 1 1/2 story  
 Year Built 1922  
 # of Stories 1.5  
 Above-Grade Living Area 1212 SF  
 Foundation 1/2 Bsmt, 1/4 Crawl  
 Basement Area 448 SF  
 Basement Finished  
 Recroom Finished 0 SF  
 Total Number Rooms 7 (Does not include bathrooms)  
 Number Bedrooms 4  
 Number Full Bathrooms 1  
 Number Half Bathrooms 1  
 Heating & Cooling Forced hot air and Central AC  
 Fireplace None  
 Deck  
 Garage Detached: 1764 SF;  
 Other Features Residential Detached Garage  
 Residential Detached Garage  
 Residential Detached Garage  
 Residential Detached Garage

## Valuation

	2024	2023	2022	2021	2020	2019	2018
+ NADS	\$15,000	\$12,500	\$11,900	\$11,900	\$10,800	\$8,300	\$7,500
+ NAD1S	\$77,300	\$77,300	\$69,100	\$62,800	\$67,700	\$67,700	\$67,700
= Total Value	\$92,300	\$89,800	\$81,000	\$74,700	\$78,500	\$76,000	\$75,200

Disclaimer: All values reflect full and true values before any adjustments or exemptions are applied.

## Taxation

2023	1st Half	2nd Half	Full Year
Due Date	April 30, 2024	October 31, 2024	
Tax Billed	803.58	803.58	1,607.16
Specials Etc.	0.00	0.00	0.00
Amount Paid	803.58	803.58	1,607.16
Amount Due	0.00	0.00	0.00
Payment Status	Paid	Paid	
Date Paid	05/22/2024	09/17/2024	

2022	1st Half	2nd Half	Full Year
Due Date	April 30, 2023	October 31, 2023	

2022	1st Half	2nd Half	Full Year
Tax Billed	746.79	746.79	1,493.58
Specials Etc.	0.00	0.00	0.00
Amount Paid	746.79	746.79	1,493.58
Amount Due	0.00	0.00	0.00
Payment Status	Paid	Paid	
Date Paid	05/02/2023	09/25/2023	

2021	1st Half	2nd Half	Full Year
Due Date	April 30, 2022	October 31, 2022	
Tax Billed	698.15	698.15	1,396.30
Specials Etc.	0.00	0.00	0.00
Amount Paid	698.15	698.15	1,396.30
Amount Due	0.00	0.00	0.00
Payment Status	Paid	Paid	
Date Paid	04/27/2022	10/26/2022	

2020	1st Half	2nd Half	Full Year
Due Date	April 30, 2021	October 31, 2021	
Tax Billed	750.32	750.32	1,500.64
Specials Etc.	0.00	0.00	0.00
Amount Paid	750.32	750.32	1,500.64
Amount Due	0.00	0.00	0.00
Payment Status	Paid	Paid	
Date Paid	04/07/2021	10/27/2021	

2019	1st Half	2nd Half	Full Year
Due Date	April 30, 2020	October 31, 2020	
Tax Billed	700.45	700.45	1,400.90
Specials Etc.	0.00	0.00	0.00
Amount Paid	700.45	700.45	1,400.90
Amount Due	0.00	0.00	0.00
Payment Status	Payment still due	Payment still due	
Date Paid	04/30/2020	12/23/2020	

2018	1st Half	2nd Half	Full Year
Due Date	April 30, 2019	October 31, 2019	
Tax Billed	702.01	702.01	1,404.02
Specials Etc.	0.00	0.00	0.00
Amount Paid	702.01	702.01	1,404.02
Amount Due	0.00	0.00	0.00
Payment Status	Paid	Paid	
Date Paid	04/24/2019	10/24/2019	

2017	1st Half	2nd Half	Full Year
Due Date	April 30, 2018	October 31, 2018	
Tax Billed	703.61	703.61	1,407.22
Specials Etc.	0.00	0.00	0.00
Amount Paid	703.61	703.61	1,407.22
Amount Due	0.00	0.00	0.00
Payment Status	Paid	Paid	
Date Paid	04/13/2018	07/30/2018	

Photos



Sketches

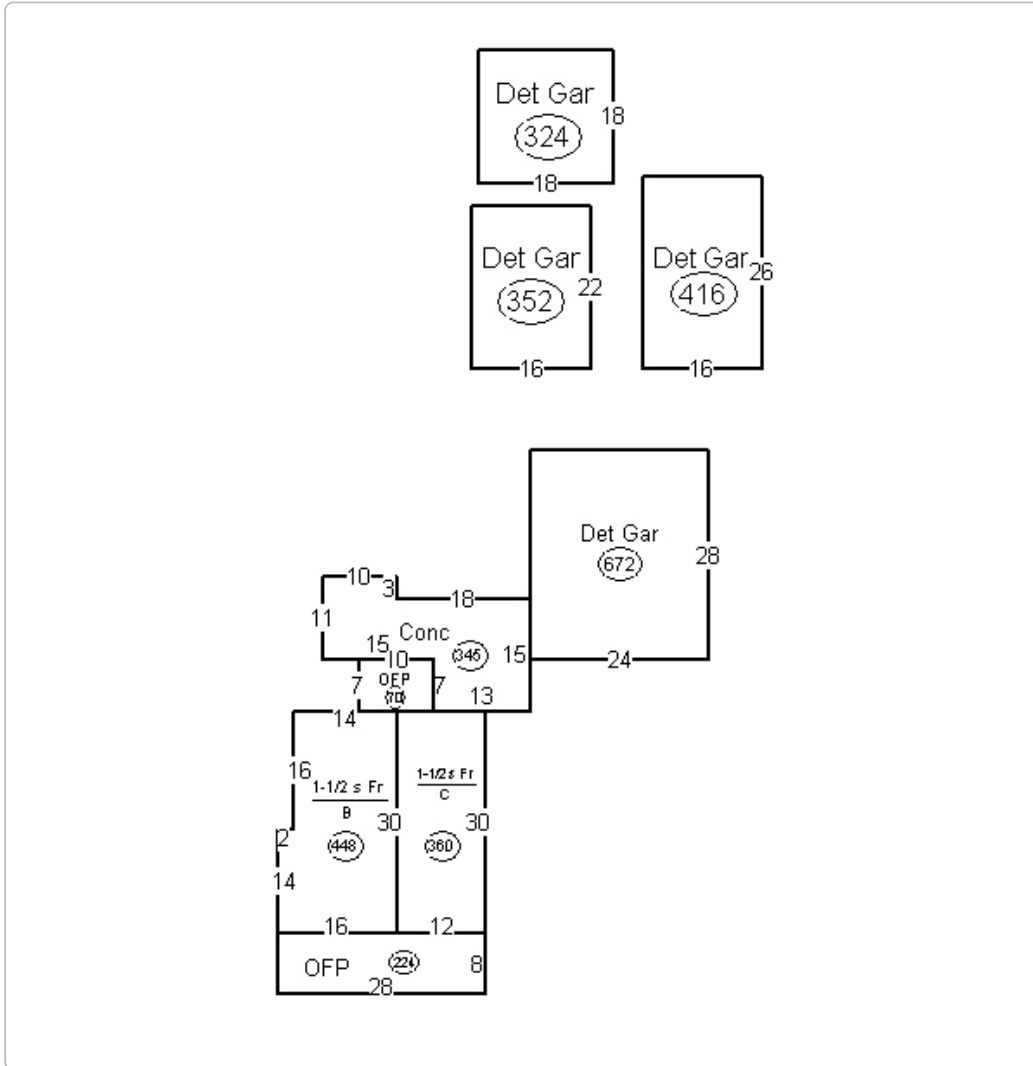

No data available for the following modules: Sales, Comments.

Brookings County digital cadastral data are a representation of recorded plats and surveys for use within the Geographic Information System for purposes of data access and analysis. These and other digital data do not replace or modify land surveys, deeds, and/or other legal instruments defining land ownership or use.

[User Privacy Policy](#) | [GDPR Privacy Notice](#)  
Last Data Upload: 9/30/2024, 12:03:14 AM

Contact Us

