

Tract 1 Soils Map

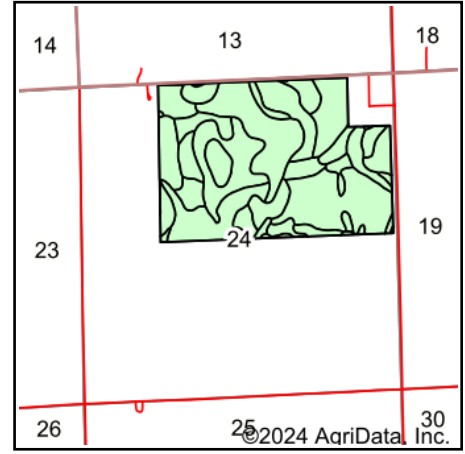
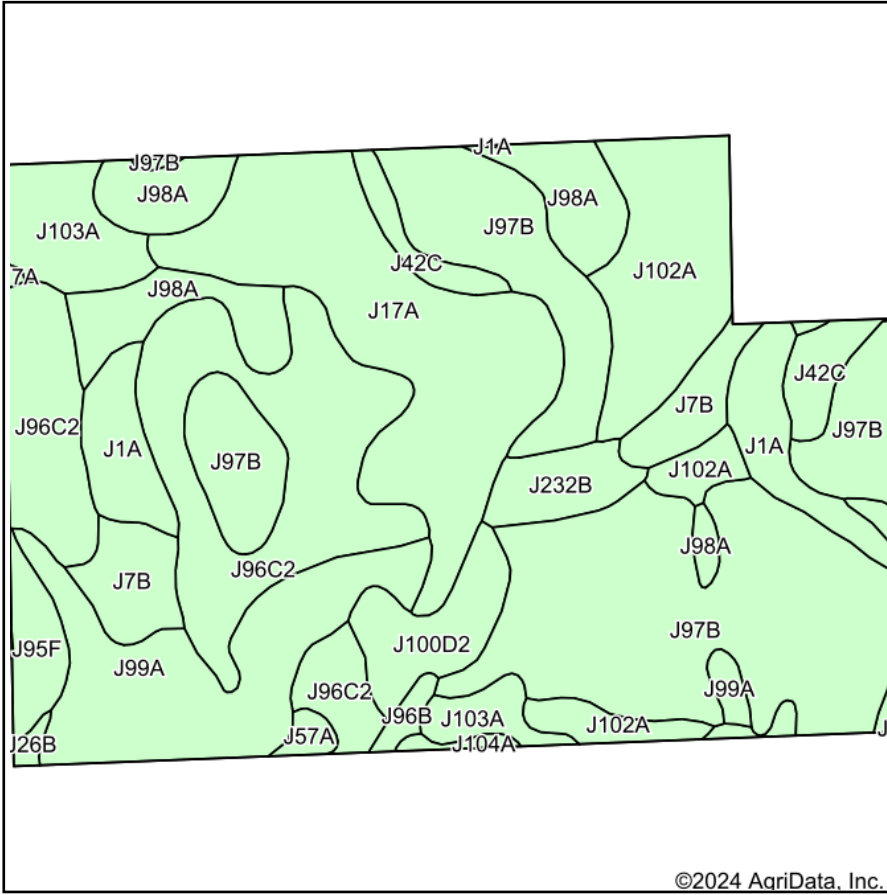

State: **Minnesota**
 County: **Lincoln**
 Location: **24-110N-46W**
 Township: **Drammen**
 Acres: **220**
 Date: **10/22/2024**

**BURLAGE
 PETERSON**
 Auctioneers & Realtors, LLC

Maps Provided By:

 CUSTOMIZED ONLINE MAPPING
 © AgriData, Inc. 2023 www.AgriDataInc.com



Soils data provided by USDA and NRCS.

©2024 AgriData, Inc.

Area Symbol: MN081, Soil Area Version: 22

Code	Soil Description	Acres	Percent of field	Non-Irr Class	Productivity Index	*n NCCPI Overall
J97B	Singsaas-Oak Lake complex, 1 to 6 percent slopes	57.43	25.9%	Ile	97	66
J96C2	Barnes-Buse complex, 6 to 12 percent slopes, moderately eroded	33.38	15.2%	Ve	80	59
J17A	Quam silty clay loam, depressional, 0 to 1 percent slopes	28.49	13.0%	IIIw	88	71
J99A	Lakepark clay loam, 0 to 3 percent slopes, overwash	19.04	8.7%	IIw	98	71
J102A	Oak Lake silty clay loam, 1 to 3 percent slopes	17.41	7.9%	Ie	99	70
J98A	Parnell silty clay loam, 0 to 2 percent slopes	14.41	6.6%	IIw	93	65
J103A	Winger silty clay loam, 0 to 2 percent slopes	10.49	4.8%	IIw	90	75
J1A	Parnell silty clay loam, depressional, 0 to 1 percent slopes	10.07	4.6%	IIIw	86	62
J7B	Sverdrup sandy loam, 2 to 6 percent slopes	7.95	3.6%	IIIe	49	44
J100D2	Buse, eroded-Wilno complex, 12 to 18 percent slopes	6.13	2.8%	IVe	64	50
J42C	Sandberg-Arvilla complex, 6 to 12 percent slopes	4.93	2.2%	Vs	38	31
J232B	Barnes, occasional saturation-Buse-Arvilla complex, 2 to 6 percent slopes	4.09	1.9%	IIIe	74	58
J95F	Buse, stony-Wilno complex, 25 to 40 percent slopes	3.38	1.5%	VIIe	17	16
J96B	Barnes, occasional saturation-Buse complex, 3 to 6 percent slopes	0.93	0.4%	Ile	88	65
J57A	Balaton loam, 1 to 3 percent slopes	0.85	0.4%	IIIs	96	70
J104A	Svea loam, 1 to 3 percent slopes	0.56	0.3%	Ie	99	70
J26B	Darnen loam, 2 to 6 percent slopes	0.46	0.2%	Ile	99	72
Weighted Average				2.80	86.7	*n 63.6

*n: The aggregation method is "Weighted Average using all components"

Soils data provided by USDA and NRCS.

Tract 3 & 4 Soils Map

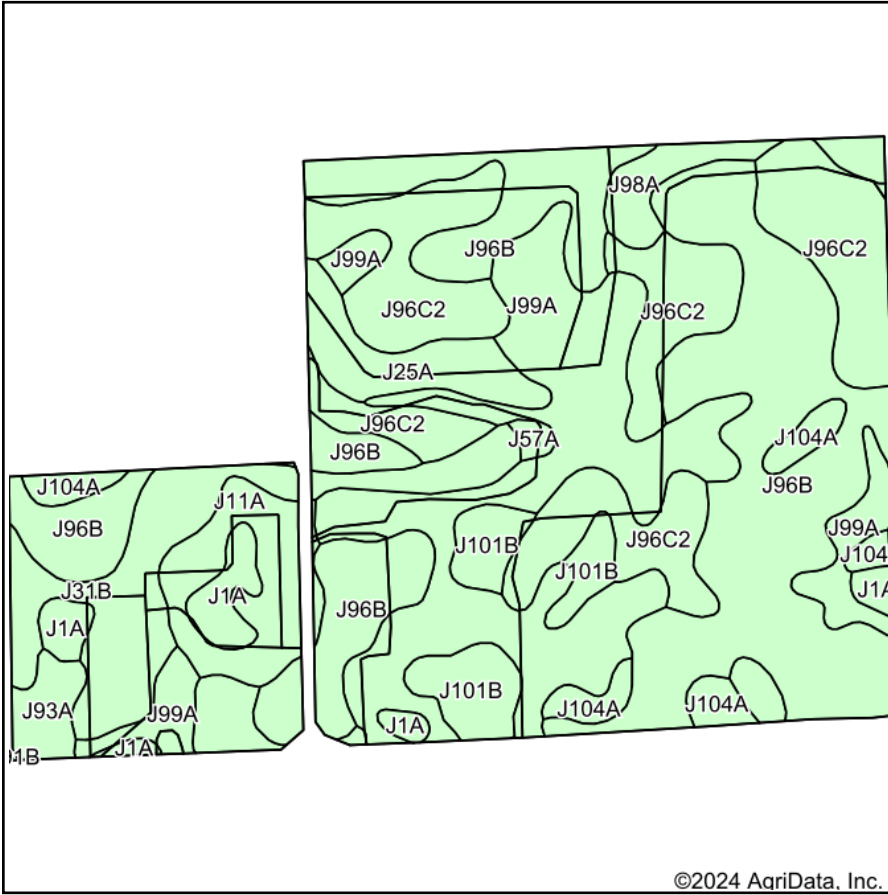

Soils data provided by USDA and NRCS.

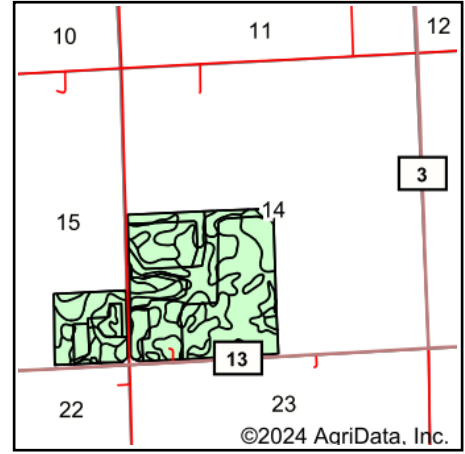

State: **Minnesota**
 County: **Lincoln**
 Location: **14-110N-46W**
 Township: **Drammen**
 Acres: **195.06**
 Date: **10/22/2024**

**BURLAGE
 PETERSON**

Auctioneers & Realtors, LLC

Maps Provided By:



© AgriData, Inc. 2023

www.AgriDataInc.com



Area Symbol: MN081, Soil Area Version: 22

Code	Soil Description	Acres	Percent of field	Non-Irr Class	Productivity Index	*n NCCPI Overall
J96B	Barnes, occasional saturation-Buse complex, 3 to 6 percent slopes	60.07	30.6%	Ile	88	65
J99A	Lakepark clay loam, 0 to 3 percent slopes, overwash	40.51	20.8%	IIw	98	71
J96C2	Barnes-Buse complex, 6 to 12 percent slopes, moderately eroded	36.39	18.7%	Ve	80	59
J31B	Arvilla-Sandberg complex, 2 to 6 percent slopes	15.00	7.7%	IIIIs	39	32
J11A	Vallers clay loam, 0 to 2 percent slopes	8.19	4.2%	IIw	90	68
J104A	Svea loam, 1 to 3 percent slopes	7.94	4.1%	Ie	99	70
J101B	Hokans-Svea complex, 1 to 4 percent slopes	7.77	4.0%	Ile	98	68
J25A	Rauville silty clay loam, 0 to 1 percent slopes, frequently flooded	6.34	3.3%	Vlw	20	36
J1A	Parnell silty clay loam, depressional, 0 to 1 percent slopes	5.40	2.8%	IIIw	86	62
J98A	Parnell silty clay loam, 0 to 2 percent slopes	4.14	2.1%	IIw	93	65
J93A	Hidewood-Badger complex, 0 to 2 percent slopes	2.72	1.4%	IIw	92	70
J57A	Balaton loam, 1 to 3 percent slopes	0.59	0.3%	IIs	96	70
Weighted Average				2.75	83.7	*n 62.1

*n: The aggregation method is "Weighted Average using all components"

Soils data provided by USDA and NRCS.