

This form is available electronically.

CRP-1 (07-23-10) U.S. DEPARTMENT OF AGRICULTURE Commodity Credit Corporation CONSERVATION RESERVE PROGRAM CONTRACT <small>NOTE: The authority for collecting the following information is Pub. L. 107-171. This authority allows for the collection of information without prior OMB approval mandated by the Paperwork Reduction Act of 1995. The time required to complete this information collection estimated to average 4 minutes per response, including the time for reviewing instructions, searching existing data sources, gathering and maintaining the data needed, and completing and reviewing the collection of information.</small>	1. ST. & CO. CODE & ADMIN. LOCATION 46039	2. SIGN-UP NUMBER 47
	3. CONTRACT NUMBER 11094	4. ACRES FOR ENROLLMENT 266.53
7. COUNTY OFFICE ADDRESS (Include Zip Code): DEUEL COUNTY FARM SERVICE AGENCY 222 4TH AVE S CLEAR LAKE, SD 57226 TELEPHONE NUMBER (Include Area Code): (605)874-8225	5. FARM NUMBER 0004467	6. TRACT NUMBER(S) 0003783
	8. OFFER (Select one) GENERAL <input type="checkbox"/> ENVIRONMENTAL PRIORITY <input checked="" type="checkbox"/>	9. CONTRACT PERIOD FROM: 11/01/15 TO: 09/30/30 (MM-DD-YYYY) (MM-DD-YYYY)

COPY

THIS CONTRACT is entered into between the Commodity Credit Corporation (referred to as "CCC") and the undersigned owners, operators, or tenants (who may be referred to as "the Participant"). The Participant agrees to place the designated acreage into the Conservation Reserve Program ("CRP") or other use set by CCC for the stipulated contract period from the date the contract is executed by the CCC. The Participant also agrees to implement on such designated acreage the Conservation Plan developed for such acreage and approved by the CCC and the Participant. Additionally, the Participant and CCC agree to comply with terms and conditions contained in this Contract, including the Appendix to this Contract, entitled Appendix to CRP-1, Conservation Reserve Program Contract (referred to as "Appendix"). By signing below, the Participant acknowledges that a copy of the Appendix for the applicable sign-up period has been provided to such person. Such person also agrees to pay such liquidated damages in an amount specified in the Appendix if the Participant withdraws prior to CCC acceptance or rejection.

The terms and conditions of this contract are contained in this Form CRP-1 and in the CRP-1 Appendix and any addendum thereto. BY SIGNING THIS CONTRACT PRODUCERS ACKNOWLEDGE RECEIPT OF THE FOLLOWING FORMS: CRP-1, CRP-1 Appendix and any addendum thereto, CRP-2 or CRP-2C, if applicable; and, if applicable, CRP-15.

10A. Rental Rate Per Acre \$183.01	11. Identification of CRP Land (See Page 2 for additional space)				
B. Annual Contract Payment \$48778	A. Tract No.	B. Field No.	C. Practice No.	D. Acres	E. Total Estimated Cost-Share
C. First Year Payment	0003783	0001	CP37	62.48	\$0.00
(Item 10C applicable only to continuous signup when the first year payment is prorated.)	0003783	0002	CP37	99.12	\$0.00
	0003783	0003	CP37	104.93	\$0.00

12. PARTICIPANTS					
A PARTICIPANT'S NAME AND ADDRESS (Zip Code): AOC FARMS LLC 47717 166TH ST REVILLO, SD 57259-5110	(2) SHARE 100.00%	(3) SOCIAL SECURITY NUMBER:	(4) SIGNATURE	DATE (MM-DD-YYYY) 9/15/15	
B PARTICIPANT'S NAME AND ADDRESS (Zip Code): DENNIS COLLINS 204 E JOHNSON AVE STOCKHOLM, SD 57264-6135	(2) SHARE 0.00%	(3) SOCIAL SECURITY NUMBER:	(4) SIGNATURE	DATE (MM-DD-YYYY) 9/15/15	
C PARTICIPANT'S NAME AND ADDRESS (Zip Code): BRUCE COLLINS 3200 11TH ST S UNT 210 FARGO, ND 58104-4610 <small>(If more than three individuals are signing, continue on attachment.)</small>	(2) SHARE 0.00%	(3) SOCIAL SECURITY NUMBER:	(4) SIGNATURE	DATE (MM-DD-YYYY) 9/15/15	
13. CCC USE ONLY - Payments according to the shares are approved.	A. SIGNATURE OF CCC REPRESENTATIVE		B. DATE (MM-DD-YYYY) 9/18/15		

NOTE: The following statement is made in accordance with the Privacy Act of 1974 (5 USC 552a) and the Paperwork Reduction Act of 1995, as amended. The authority for requesting the following information is the Food Security Act of 1985, (Pub. L. 99-198), as amended and the Farm Security and Rural Investment Act of 2002 (Pub. L. 107-171) and regulations promulgated at 7 CFR Part 1410 and the Internal Revenue code (26 USC 6109). The information requested is necessary for CCC to consider and process the offer to enter into a Conservation Reserve Program Contract, to assist in determining eligibility and to determine the correct parties to the contract. Furnishing the requested information is voluntary. Failure to furnish the requested information will result in determination of ineligibility for certain program benefits and other financial assistance administered by USDA agency. This information may be provided to other agencies, IRS, Department of Justice, or other State and Federal Law Enforcement agencies, and in response to a court magistrate or administrative tribunal. The provisions of criminal and civil fraud statutes, including 18 USC 286, 287, 371, 641, 651, 1001; 15 USC 714m; and 31 USC 3729, may be applicable to the information provided.

RETURN THIS COMPLETED FORM TO YOUR COUNTY FSA OFFICE.

The U.S. Department of Agriculture (USDA) prohibits discrimination in all its programs and activities on the basis of race, color, national origin, age, disability, and where applicable, sex, marital status, familial status, parental status, religion, sexual orientation, genetic information, political beliefs, genetic information, reprisal, or because all or part of an individual's income is derived from any public assistance program. (Not all prohibited bases apply to all programs.) Persons with disabilities who require alternative means for communication of program information (Braille, large print, audiotape, etc.) should contact USDA's TARGET Center at (202) 720-2600 (voice and TDD). To file a complaint of discrimination, write to USDA, Director, Office of Civil Rights, 1400 Independence Avenue, S.W., Washington, D.C. 20250-9410, or call (800) 795-3272 (voice) or (202) 720-6382 (TDD). USDA is an equal opportunity provider and employer.

Original - County Office Copy
 Owner's Copy
 Operator's Copy

COPY

Continuation of Item 12 - PARTICIPANTS

D PARTICIPANT'S NAME AND ADDRESS (Zip Code): JOHN COLLINS 47717 166TH ST REVILLO, SD 57259-5110	(2) SHARE 0.00%	(3) SOCIAL SECURITY NUMBER: (4) SIGNATURE <i>X John Collins</i>	DATE (MM/DD/YYYY) 9/15/15
E PARTICIPANT'S NAME AND ADDRESS (Zip Code):	(2) SHARE %	(3) SOCIAL SECURITY NUMBER: (4) SIGNATURE	DATE (MM/DD/YYYY)
F PARTICIPANT'S NAME AND ADDRESS (Zip Code):	(2) SHARE %	(3) SOCIAL SECURITY NUMBER: (4) SIGNATURE	DATE (MM/DD/YYYY)

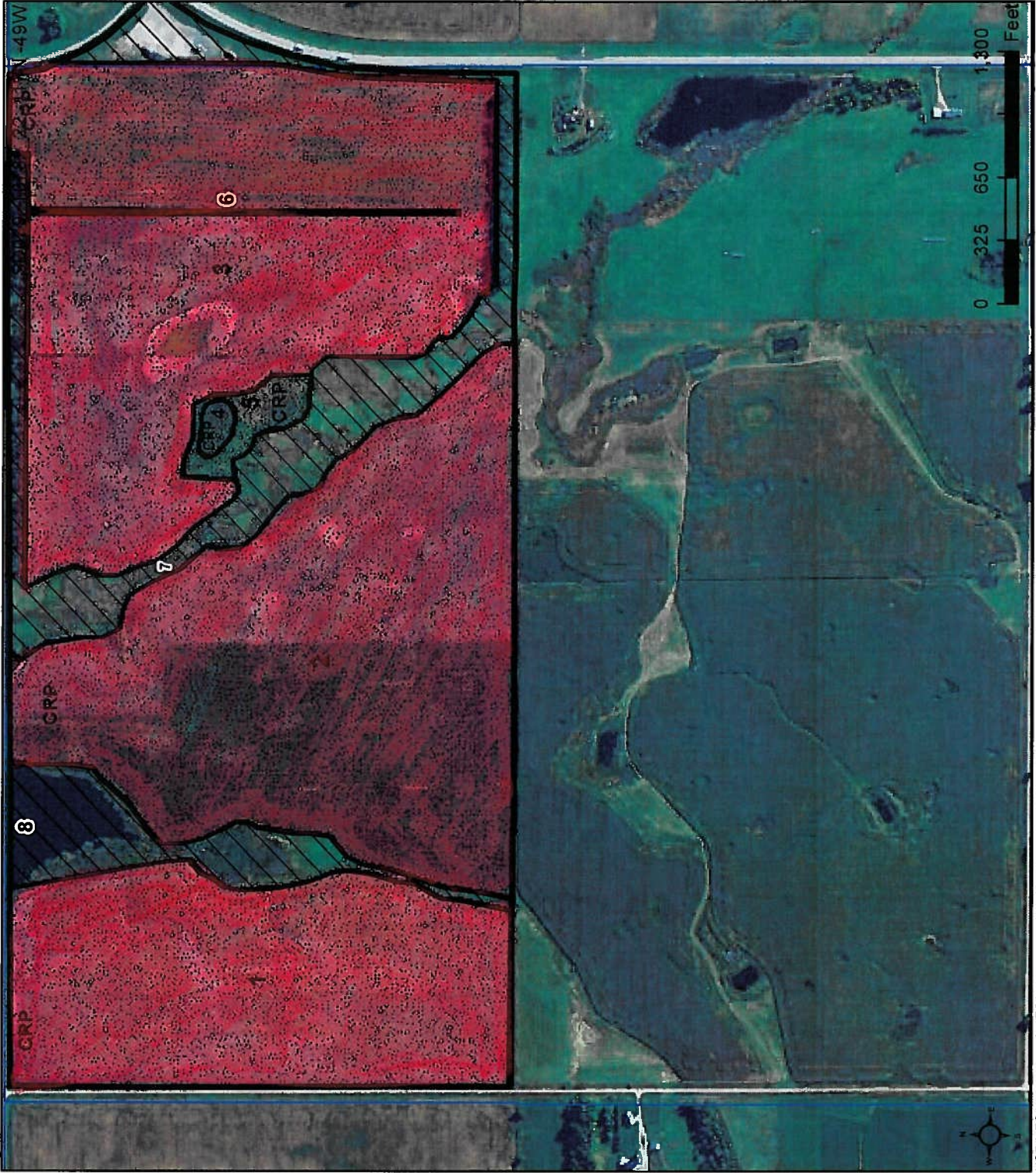

CLU	Acres	HEL	Crop
1	62.48	NHEL	CRP
2	99.12	NHEL	CRP
3	104.93	NHEL	CRP
4	0.94	NHEL	CRP
5	3.7	NHEL	CRP
6	0.82	UHEL	
7	32.67	UHEL	
8	14.54	UHEL	

Page Cropland Total: 271.17 ac

Map Created December 14, 2015

Common Land Unit

- Rangeland
- Cropland
- CRP
- Tract Boundary
- PLSS

Wetland Determination Identifiers

- Restricted Use
- Limited Restrictions
- Exempt from Conservation
- Compliance Provisions

USDA FSA maps are for FSA Program administration only. This map does not represent a legal survey or reflect actual ownership; rather it depicts the information provided directly from the producer and/or the NAIP imagery. The producer accepts the data 'as is' and assumes all risks associated with its use. The USDA Farm Service Agency assumes no responsibility for actual or consequential damage incurred as a result of any user's reliance on this data outside FSA Programs. Wetland identifiers do not represent the size, shape, or specific determination of the area. Refer to your original determination (CPA-026 and attached maps) for exact boundaries and determinations or contact NRCS.

This form is available electronically.

CRP-1 (07-23-10) U.S. DEPARTMENT OF AGRICULTURE Commodity Credit Corporation CONSERVATION RESERVE PROGRAM CONTRACT <small>NOTE: The authority for collecting the following information is Pub. L. 107-171. This authority allows for the collection of information without prior OMB approval mandated by the Paperwork Reduction Act of 1995. The time required to complete this information collection estimated to average 4 minutes per response, including the time for reviewing instructions, searching existing data sources, gathering and maintaining the data needed, and completing and reviewing the collection of information.</small>	1. ST. & CO. CODE & ADMIN. LOCATION 46039	2. SIGN-UP NUMBER 47
	3. CONTRACT NUMBER 11093	4. ACRES FOR ENROLLMENT 4.64
7. COUNTY OFFICE ADDRESS (Include Zip Code): DEUEL COUNTY FARM SERVICE AGENCY 222 4TH AVE S CLEAR LAKE, SD 57226	5. FARM NUMBER 0004467	6. TRACT NUMBER(S) 0003783
TELEPHONE NUMBER (Include Area Code): (605)874-8225	8. OFFER (Select one) GENERAL <input type="checkbox"/> ENVIRONMENTAL PRIORITY <input checked="" type="checkbox"/>	9. CONTRACT PERIOD FROM: 11/01/15 TO: 09/30/30 (MM-DD-YYYY) (MM-DD-YYYY)

THIS CONTRACT is entered into between the Commodity Credit Corporation (referred to as "CCC") and the undersigned owners, operators, or tenants (who may be referred to as "the Participant"). The Participant agrees to place the designated acreage into the Conservation Reserve Program ("CRP") or other use set by CCC for the stipulated contract period from the date the contract is executed by the CCC. The Participant also agrees to implement on such designated acreage the Conservation Plan developed for such acreage and approved by the CCC and the Participant. Additionally, the Participant and CCC agree to comply with terms and conditions contained in this Contract, including the Appendix to this Contract, entitled Appendix to CRP-1, Conservation Reserve Program Contract (referred to as "Appendix"). By signing below, the Participant acknowledges that a copy of the Appendix for the applicable sign-up period has been provided to such person. Such person also agrees to pay such liquidated damages in an amount specified in the Appendix if the Participant withdraws prior to CCC acceptance or rejection.

The terms and conditions of this contract are contained in this Form CRP-1 and in the CRP-1 Appendix and any addendum thereto. BY SIGNING THIS CONTRACT PRODUCERS ACKNOWLEDGE RECEIPT OF THE FOLLOWING FORMS: CRP-1, CRP-1 Appendix and any addendum thereto, CRP-2 or CRP-2C, if applicable; and, if applicable, CRP-15.

10A. Rental Rate Per Acre \$166.51	11. Identification of CRP Land (See Page 2 for additional space)				
B. Annual Contract Payment \$773	A. Tract No.	B. Field No.	C. Practice No.	D. Acres	E. Total Estimated Cost-Share
C. First Year Payment	0003783	0004	CP27	0.94	\$0.00
(Item 10C applicable only to continuous signup when the first year payment is prorated.)	0003783	0005	CP28	3.70	\$0.00

12. PARTICIPANTS					
A PARTICIPANT'S NAME AND ADDRESS (Zip Code): AOC FARMS LLC 47717 166TH ST REVILLO, SD 57259-5110	(2) SHARE 100.00%	(3) SOCIAL SECURITY NUMBER:			
		(4) SIGNATURE <i>[Signature]</i> <small>(If more than three individuals are signing, continue on attachment.)</small>	DATE (MM-DD-YYYY) 9/15/15		
B PARTICIPANT'S NAME AND ADDRESS (Zip Code): DENNIS COLLINS 204 E JOHNSON AVE STOCKHOLM, SD 57264-6135	(2) SHARE 0.00%	(3) SOCIAL SECURITY NUMBER:			
		(4) SIGNATURE <i>[Signature]</i> <small>(If more than three individuals are signing, continue on attachment.)</small>	DATE (MM-DD-YYYY) 9/15/15		
C PARTICIPANT'S NAME AND ADDRESS (Zip Code): BRUCE COLLINS 3200 11TH ST S UNT 210 FARGO, ND 58104-4610 <small>(If more than three individuals are signing, continue on attachment.)</small>	(2) SHARE 0.00%	(3) SOCIAL SECURITY NUMBER:			
		(4) SIGNATURE <i>[Signature]</i> <small>(If more than three individuals are signing, continue on attachment.)</small>	DATE (MM-DD-YYYY) 9/15/15		
13. CCC USE ONLY - Payments according to the shares are approved.	A. SIGNATURE OF CCC REPRESENTATIVE <i>[Signature]</i>		B. DATE (MM-DD-YYYY) 9/18/15		

NOTE: The following statement is made in accordance with the Privacy Act of 1974 (5 USC 552a) and the Paperwork Reduction Act of 1995, as amended. The authority for requesting the following information is the Food Security Act of 1985, (Pub. L. 99-198), as amended and the Farm Security and Rural Investment Act of 2002 (Pub. L. 107-171) and regulations promulgated at 7 CFR Part 1410 and the Internal Revenue code (26 USC 6109). The information requested is necessary for CCC to consider and process the offer to enter into a Conservation Reserve Program Contract, to assist in determining eligibility and to determine the correct parties to the contract. Furnishing the requested information is voluntary. Failure to furnish the requested information will result in determination of ineligibility for certain program benefits and other financial assistance administered by USDA agency. This information may be provided to other agencies, IRS, Department of Justice, or other State and Federal Law Enforcement agencies, and in response to a court magistrate or administrative tribunal. The provisions of criminal and civil fraud statutes, including 18 USC 286, 287, 371, 641, 651, 1001; 15 USC 714m; and 31 USC 3729, may be applicable to the information provided.

RETURN THIS COMPLETED FORM TO YOUR COUNTY FSA OFFICE.

The U.S. Department of Agriculture (USDA) prohibits discrimination in all its programs and activities on the basis of race, color, national origin, age, disability, and where applicable, sex, marital status, familial status, parental status, religion, sexual orientation, genetic information, political beliefs, genetic information, reprisal, or because all or part of an individual's income is derived from any public assistance program. (Not all prohibited bases apply to all programs.) Persons with disabilities who require alternative means for communication of program information (Braille, large print, audiotape, etc.) should contact USDA's TARGET Center at (202) 720-2600 (voice and TDD). To file a complaint of discrimination, write to USDA, Director, Office of Civil Rights, 1400 Independence Avenue, S.W., Washington, D.C. 20250-9410, or call (800) 795-3272 (voice) or (202) 720-6382 (TDD). USDA is an equal opportunity provider and employer.

Original - County Office Copy
 Owner's Copy
 Operator's Copy

Continuation of Item 12 - PARTICIPANTS

D PARTICIPANT'S NAME AND ADDRESS (Zip Code): JOHN COLLINS 47717 166TH ST REVILLO,SD 57259-5110	(2) SHARE	(3) SOCIAL SECURITY NUMBER:	
	0.00 %	(4) SIGNATURE <i>John Collins</i>	DATE (MM/DD/YYYY) 9/15/15
E PARTICIPANT'S NAME AND ADDRESS (Zip Code):	(2) SHARE	(3) SOCIAL SECURITY NUMBER:	
	%	(4) SIGNATURE	DATE (MM/DD/YYYY)
F PARTICIPANT'S NAME AND ADDRESS (Zip Code):	(2) SHARE	(3) SOCIAL SECURITY NUMBER:	
	%	(4) SIGNATURE	DATE (MM/DD/YYYY)

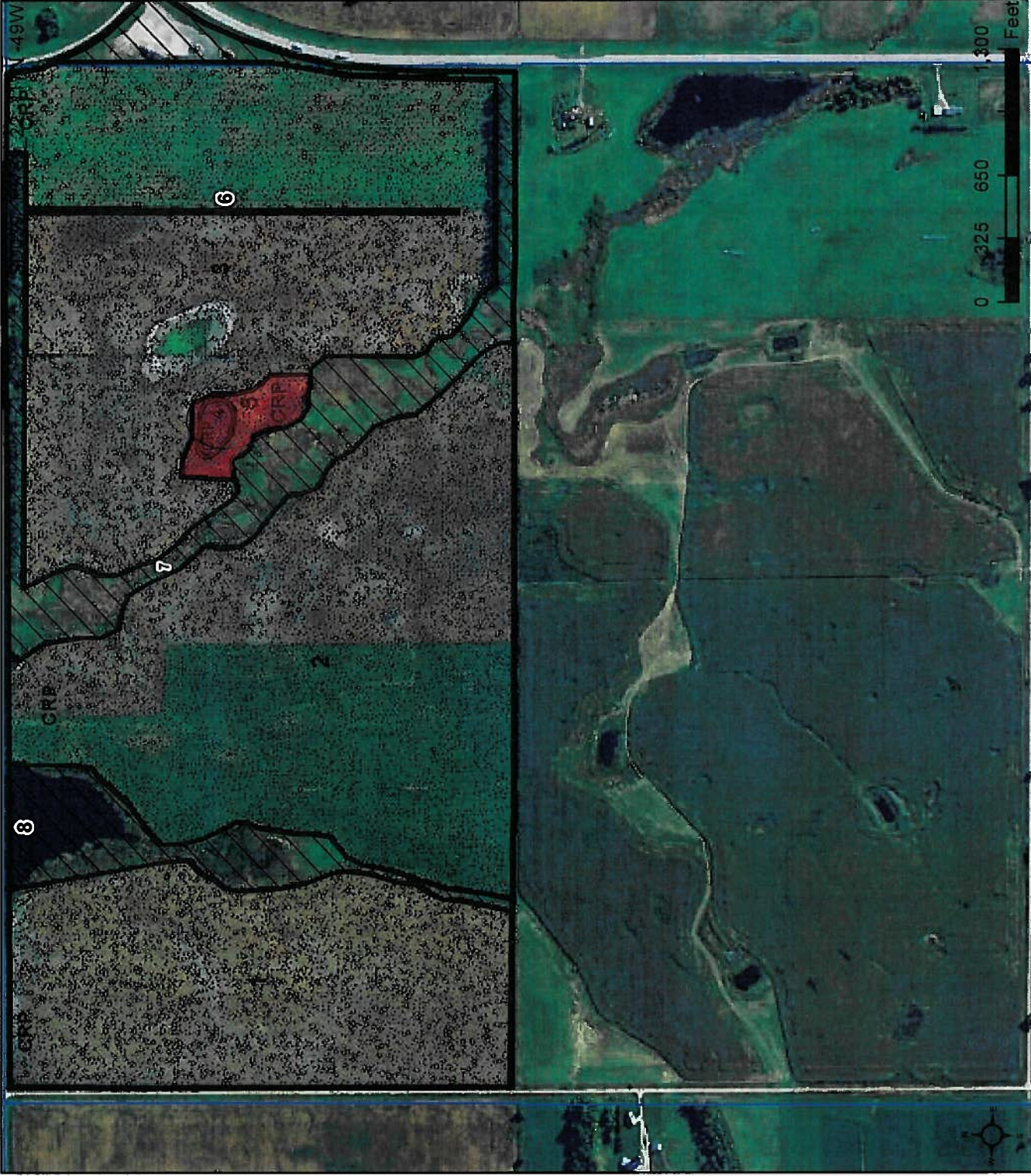

CLU/Acres	HEL	Crop
1 62.48	NHEL	CRP
2 99.12	NHEL	CRP
3 104.93	NHEL	CRP
4 0.94	NHEL	CRP
5 3.7	NHEL	CRP
6 0.82	UHEL	
7 32.67	UHEL	
8 14.54	UHEL	

Page Cropland Total: 271.17 acres

Map Created December 14, 2015

- Common Land Unit
- Rangeland
 - Cropland
 - CRP
 - Tract Boundary
 - PLSS

- Wetland Determination Identifiers
- Restricted Use
 - Limited Restrictions
 - Exempt from Conservation
 - Compliance Provisions

USDA FSA maps are for FSA Program administration only. This map does not represent a legal survey or reflect actual ownership; rather it depicts the information provided directly from the producer and/or the NAIP imagery. The producer accepts the data 'as is' and assumes all risks associated with its use. The USDA Farm Service Agency assumes no responsibility for actual or consequential damage incurred as a result of any user's reliance on this data outside FSA Programs. Wetland identifiers do not represent the size, shape, or specific determination of the area. Refer to your original determination (CPA-026 and attached maps) for exact boundaries and determinations or contact NRCS.