

Soils Map

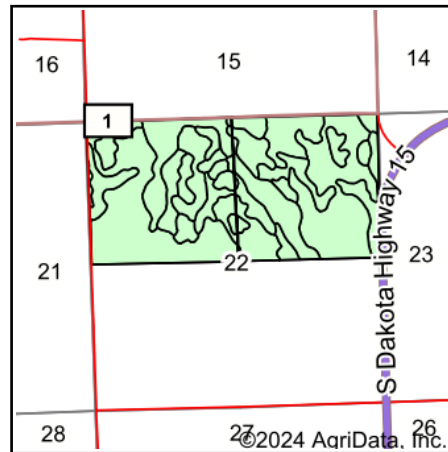
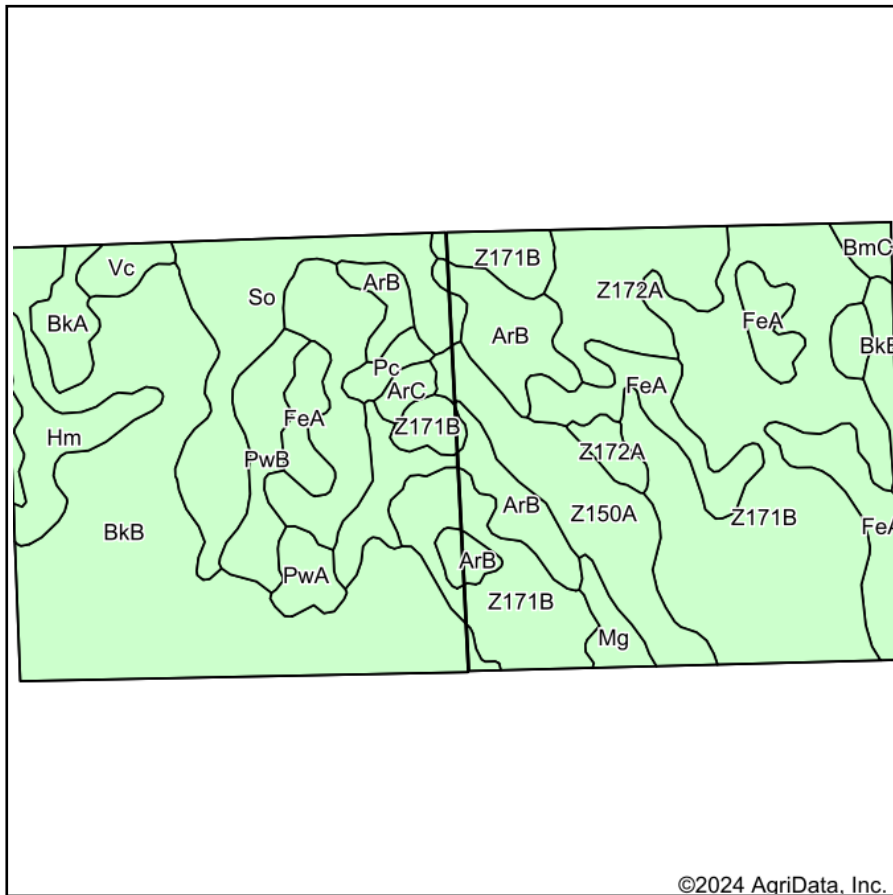

State: **South Dakota**
 County: **Deuel**
 Location: **22-117N-49W**
 Township: **Portland**
 Acres: **318.46**
 Date: **11/13/2024**

**BURLAGE
 PETERSON**

Auctioneers & Realtors, LLC

Maps Provided By:



© AgriData, Inc. 2023

www.AgriDataInc.com



Soils data provided by USDA and NRCS.

©2024 AgriData, Inc.

Area Symbol: SD039, Soil Area Version: 28

Code	Soil Description	Acres	Percent of field	Non-Irr Class	Productivity Index	*n NCCPI Overall
Z171B	Renshaw-Fordville loams, coteau, 2 to 6 percent slopes	94.73	29.8%	IVs	43	44
BkB	Barnes-Svea loams, 1 to 6 percent slopes	73.40	23.0%	Ile	83	72
ArB	Arvilla sandy loam, 2 to 6 percent slopes	27.36	8.6%	IVs	21	37
FeA	Fordville loam, coteau, 0 to 2 percent slopes	25.60	8.0%	IIs	59	54
So	Southam silty clay loam, 0 to 1 percent slopes	23.08	7.2%	VIIIw	10	36
Z150A	Rauville silty clay loam, coteau, 0 to 1 percent slopes, frequently flooded	18.57	5.8%	Vw	23	47
Z172A	Renshaw loam, coteau, 0 to 2 percent slopes	17.71	5.6%	IIIIs	41	40
Hm	Hamerly-Badger complex, 0 to 2 percent slopes	8.67	2.7%	IIs	78	62
PwB	Poinsett-Waubay silty clay loams, 1 to 6 percent slopes	8.47	2.7%	Ile	89	73
BkA	Barnes-Svea loams, 0 to 2 percent slopes	4.79	1.5%	Ie	75	73
PwA	Poinsett-Waubay silty clay loams, 0 to 2 percent slopes	3.72	1.2%	Is	93	75
Mg	Marysland loam	3.21	1.0%	IVw	46	35
Vc	Vallers loam	2.97	0.9%	IVw	49	56
Pc	Parnell-Vallers complex	2.33	0.7%	Vw	40	43
BmC	Barnes-Svea-Buse loams, 2 to 9 percent slopes	2.08	0.7%	IIIe	64	65
ArC	Arvilla sandy loam, 6 to 9 percent slopes	1.77	0.6%	IVe	14	37
Weighted Average				3.48	51.2	*n 52.2

*n: The aggregation method is "Weighted Average using all components"

Soils data provided by USDA and NRCS.