

CKS Partners, LLC - Soils Map

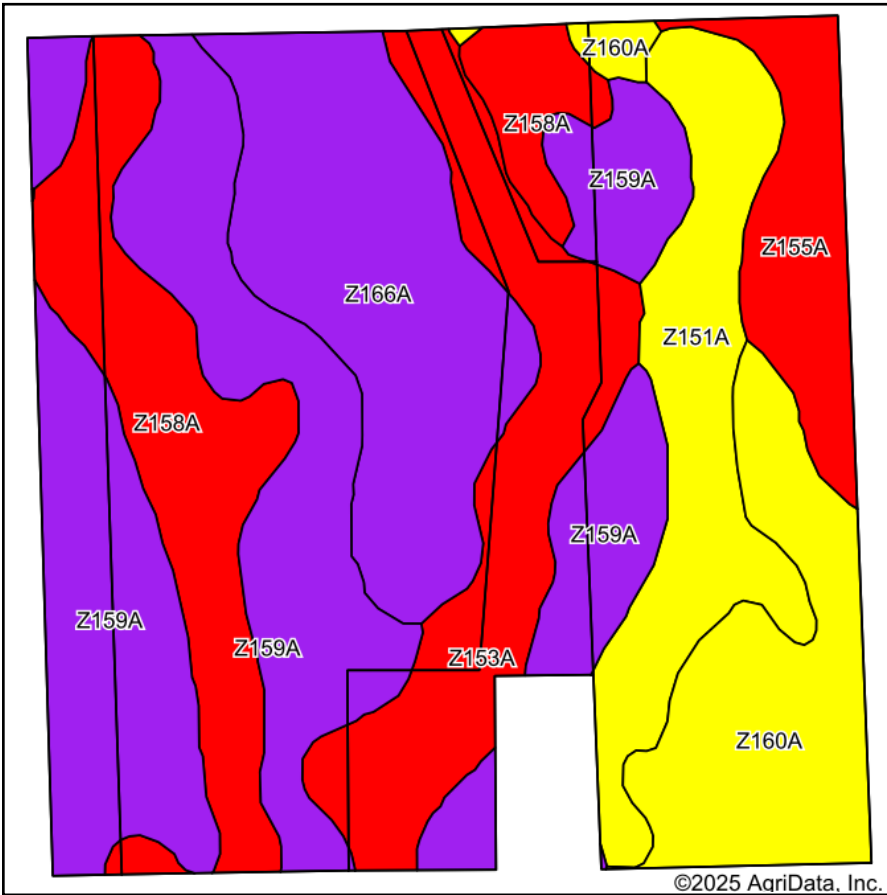

Soils data provided by USDA and NRCS.

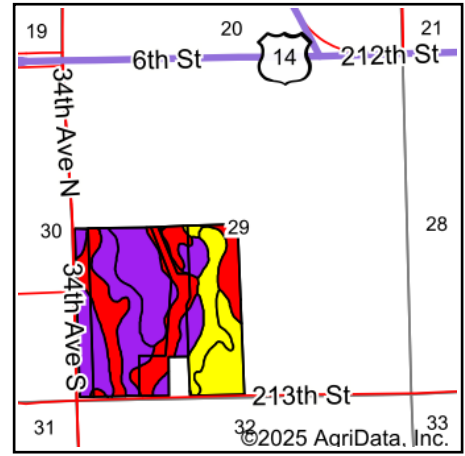

State: **South Dakota**
 County: **Brookings**
 Location: **29-110N-49W**
 Township: **Aurora**
 Acres: **150.96**
 Date: **1/7/2025**



Area Symbol: SD011, Soil Area Version: 32

Code	Soil Description	Acres	Percent of field	PI Legend	Non-Irr Class *c	Productivity Index
Z159A	Divide loam, 0 to 2 percent slopes, occasionally flooded	45.14	29.9%		IIIs	54
Z166A	Fordtown loam, 0 to 2 percent slopes, rarely flooded	24.97	16.5%		IIs	60
Z158A	Marysland loam, 0 to 1 percent slopes, occasionally flooded	20.92	13.9%		IVw	32
Z153A	Lamoure-Rauville silty clay loams, channeled, 0 to 2 percent slopes, frequently flooded	18.20	12.1%		VIw	13
Z160A	Moritz, occasionally flooded-Lamoure, frequently flooded, complex, 0 to 2 percent slopes	16.76	11.1%		IIs	65
Z151A	Castlewood silty clay, 0 to 1 percent slopes, occasionally flooded	16.30	10.8%		IVw	62
Z155A	Lowe, occasionally flooded-Ludden, frequently flooded, complex, 0 to 1 percent slopes	8.67	5.7%		IVw	47
Weighted Average					3.39	48.7

*c: Using Capabilities Class Dominant Condition Aggregation Method

Soils data provided by USDA and NRCS.