

Fromm Grant County Soils Map

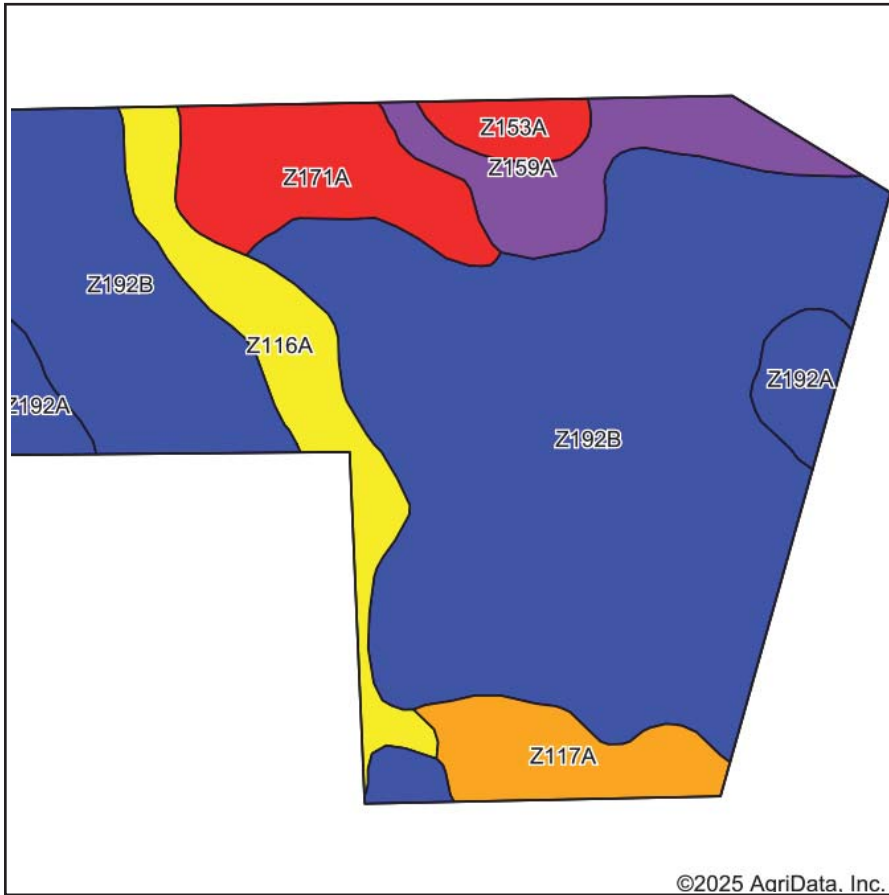

Soils data provided by USDA and NRCS.

©2025 AgriData, Inc.

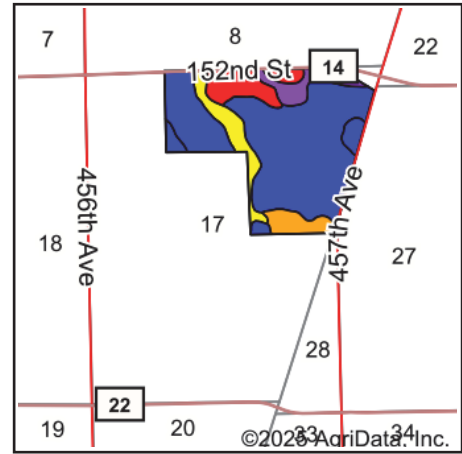

State: **South Dakota**
 County: **Grant**
 Location: **17-120N-52W**
 Township: **Lura**
 Acres: **149.63**
 Date: **3/12/2025**



Area Symbol: SD051, Soil Area Version: 26

Code	Soil Description	Acres	Percent of field	PI Legend	Non-Irr Class *c	Productivity Index
Z192B	Vienna-Brookings complex, 1 to 6 percent slopes	99.35	66.4%		Ile	86
Z116A	McKranz-Hidewood, frequently flooded, silty clay loams, 0 to 2 percent slopes	12.26	8.2%		Ils	67
Z171A	Renshaw-Fordville loams, coteau, 0 to 2 percent slopes	11.62	7.8%		IIIIs	47
Z159A	Divide loam, 0 to 2 percent slopes, occasionally flooded	9.77	6.5%		IIIIs	54
Z117A	Mckranz-Badger silty clay loams, 0 to 2 percent slopes	7.91	5.3%		IIs	79
Z192A	Vienna-Brookings complex, 0 to 2 percent slopes	5.81	3.9%		Is	90
Z153A	Lamoure-Rauville silty clay loams, channeled, 0 to 2 percent slopes, frequently flooded	2.91	1.9%		Vlw	13
Weighted Average					2.18	77.7

*c: Using Capabilities Class Dominant Condition Aggregation Method